

## Flange Dimension 2500

The following charts are for reference use only. They are based upon older piping systems. Refer to current specifications when designing new systems

### Dimensions for Class 2500 Flanges

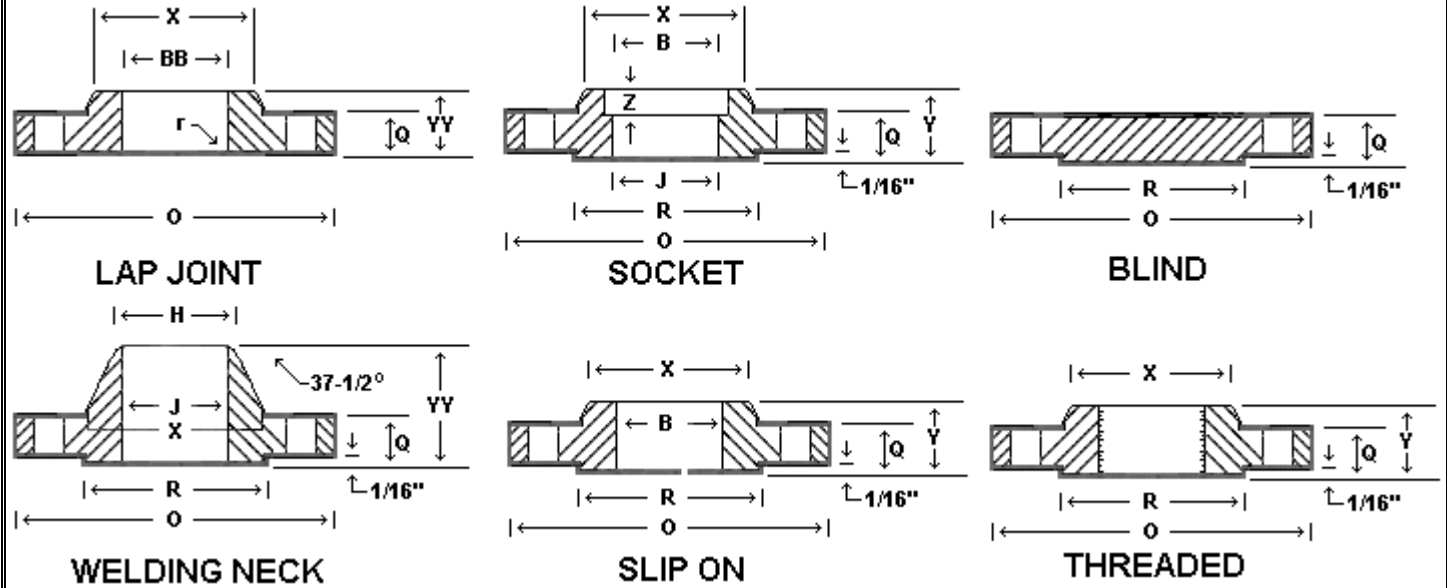

| Nom. Pipe Size<br>(inches) | O     | Q*   | R     | X     | No. and**<br>Dia of Bolt<br>Holes | Bolt<br>Circle<br>Dia. | YY*   | H     | J                                     | Y*   | B     | R     | YV    | BB   | C    | T    |  |
|----------------------------|-------|------|-------|-------|-----------------------------------|------------------------|-------|-------|---------------------------------------|------|-------|-------|-------|------|------|------|--|
| 1/2                        | 5.25  | 1.19 | 1.38  | 1.69  | 4-0.88                            | 3.50                   | 2.88  | 0.84  | To Be<br>Specified<br>by<br>Purchaser | 1.56 | .12   | 1.56  | 0.90  | 0.93 | 1.12 | 1.12 |  |
| 3/4                        | 5.50  | 1.25 | 1.69  | 2.00  | 4-0.88                            | 3.75                   | 3.12  | 1.05  |                                       | 1.69 | .12   | 1.69  | 1.11  | 1.14 | 1.25 |      |  |
| 1                          | 6.25  | 1.38 | 2.00  | 2.25  | 4-1.00                            | 4.25                   | 3.50  | 1.32  |                                       | 1.88 | .12   | 1.88  | 1.38  | 1.41 | 1.38 |      |  |
| 1 1/4                      | 7.25  | 1.50 | 2.50  | 2.88  | 4-1.12                            | 5.12                   | 3.75  | 1.66  |                                       | 2.06 | .19   | 2.06  | 1.72  | 1.75 | 1.50 |      |  |
| 1 1/2                      | 8.00  | 1.75 | 2.88  | 3.12  | 4-1.25                            | 5.75                   | 4.38  | 1.90  |                                       | 2.38 | .25   | 2.38  | 1.97  | 1.99 | 1.75 |      |  |
| 2                          | 9.25  | 2.00 | 3.62  | 3.75  | 8-1.12                            | 6.75                   | 5.00  | 2.38  |                                       | 2.75 | .31   | 2.75  | 2.46  | 2.50 | 2.00 |      |  |
| 2 1/2                      | 10.50 | 2.25 | 4.12  | 4.50  | 8-1.25                            | 7.75                   | 5.62  | 2.88  |                                       | 3.12 | .31   | 3.12  | 2.97  | 3.00 | 2.25 |      |  |
| 3                          | 12.00 | 2.62 | 5.00  | 5.25  | 8-1.38                            | 9.00                   | 6.62  | 3.50  |                                       | 3.62 | .38   | 3.62  | 3.60  | 3.63 | 2.50 |      |  |
| 4                          | 14.00 | 3.00 | 6.19  | 6.50  | 8-1.62                            | 10.75                  | 7.50  | 4.50  |                                       | 4.25 | .44   | 4.25  | 4.60  | 4.63 | 2.75 |      |  |
| 5                          | 16.50 | 3.62 | 7.31  | 8.00  | 8-1.88                            | 12.75                  | 9.00  | 5.56  |                                       | 5.12 | .44   | 5.12  | 5.69  | 5.69 | 3.00 |      |  |
| 6                          | 19.00 | 4.25 | 8.50  | 9.25  | 8-2.12                            | 14.5                   | 10.75 | 6.63  |                                       | 6.00 | .50   | 6.00  | 6.75  | 6.75 | 3.25 |      |  |
| 8                          | 21.75 | 5.00 | 10.62 | 12.00 | 12-2.12                           | 17.25                  | 12.50 | 8.63  |                                       | 7.00 | .50   | 7.00  | 8.75  | 8.75 | 3.75 |      |  |
| 10                         | 26.50 | 6.50 | 12.75 | 14.75 | 12-2.62                           | 21.25                  | 16.50 | 10.75 | 9.00                                  | .50  | 9.00  | 10.92 | 10.88 | 4.25 |      |      |  |
| 12                         | 30.00 | 7.25 | 15.00 | 17.38 | 12-2.88                           | 24.38                  | 18.25 | 12.75 | 10.00                                 | .50  | 10.00 | 12.92 | 12.94 | 4.75 |      |      |  |

**Weight (L.B.S.)\*\*\***

**Flange Types**

| Pressure Class | Nom. Size Pipe | Weld Neck | Slip-On | Thd. | Lap Joint | Blind | Socket |
|----------------|----------------|-----------|---------|------|-----------|-------|--------|
| <b>2500</b>    | 1/2            | 8         |         | 7    | 7         | 7     |        |
|                | 3/4            | 9         |         | 9    | 8         | 10    |        |
|                | 1              | 13        |         | 12   | 12        | 12    |        |
|                | 1 1/4          | 20        |         | 18   | 17        | 18    |        |
|                | 1 1/2          | 28        |         | 25   | 24        | 25    |        |
|                | 2              | 42        |         | 38   | 37        | 39    |        |
|                | 2 1/2          | 52        |         | 55   | 53        | 56    |        |
|                | 3              | 94        |         | 83   | 80        | 86    |        |
|                | 4              | 146       |         | 127  | 122       | 133   |        |
|                | 5              | 244       |         | 210  | 204       | 223   |        |
|                | 6              | 378       |         | 323  | 314       | 345   |        |
|                | 8              | 576       |         | 485  | 471       | 533   |        |
|                | 10             | 1068      |         | 925  | 897       | 1025  |        |
|                | 12             | 1608      |         | 1300 | 1262      | 1464  |        |
|                | 14             |           |         |      |           |       |        |
|                | 16             |           |         |      |           |       |        |
|                | 18             |           |         |      |           |       |        |
|                | 20             |           |         |      |           |       |        |
|                | 24             |           |         |      |           |       |        |

All dimensions given in inches.

Dimensions & tolerances in accordance with ANSI B16.5. Carbon steel flanges mechanical properties and chemistry conform to ASTM A105.

Flanges are furnished faced, drilled and spot faced or back faced.

\*1/4 in. raised face included in dimensions Q, Y and YY.

\*\*Bolt hole diameter 1/8 in. larger than bolt diameter.

\*\*\*Weights listed are approximate values.

\*\*\*\* To be specified by the customer.

**Thermometriccorp.com  
WELD NECK FLANGE**

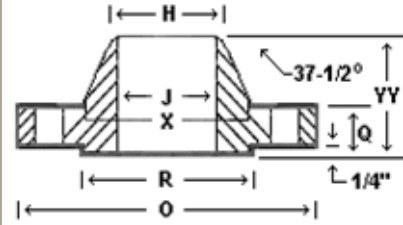

**SLIP-ON FLANGE**

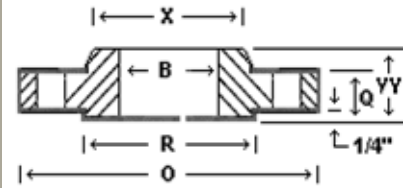

**THREADED FLANGE**

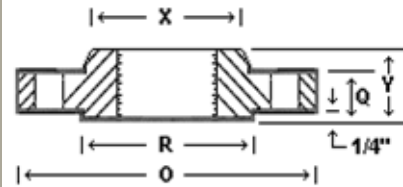

**LAP JOINT FLANGE**

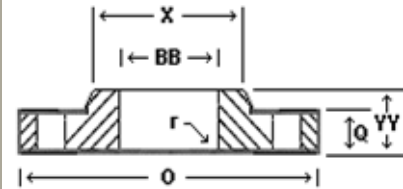

**BLIND FLANGE**

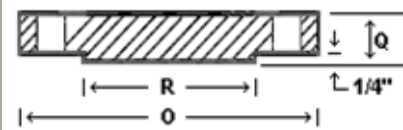

**SOCKET FLANGE**

